

WASTE AND RECYCLE CONTAINERS

Trash and recycling containers must be stored out of public sight with the exception of trash collection. It is highly recommended and encouraged that trash and recycling containers be stored in garages. The DRC will consider requests for garbage can area screens, dependent on placement and view from the public. Whenever possible, alternatives to screens are recommended and encouraged (ie landscaping and plants). It is also recommended that all screens be softened through the use of evergreen landscaping on the exterior side.

Location:

Privacy screens and other enclosures shall follow the natural topography of the land and match their surroundings.

Existing trees shall not be removed to place the screen/enclosure without prior approval from the DRC.

Screens/enclosures shall not be placed in the front yard.

Screens enclosing trash and recycling containers should be located on the garage side of the house. However, they may not be located where the use, including, but not limited to entry, of said area encroaches on a neighboring property. For homes with no garages, the screens should be placed on the back corner of the home.

Materials:

In order to maintain a uniform style throughout Wendell Falls, screens/enclosures may not exceed 54" maximum height, can be no wider than 3' and no longer than 5', and must be fully enclosed at least three sides (two sides of screen plus the original garage wall). Gate(s) no wider than 3' may be installed on either the side or rear of the enclosure; if installed, the gate(s) must be kept closed at all times except for ingress and egress of trash and recycling containers. Screens/enclosures may be constructed with wood or vinyl. Wooden containment areas must be either treated with a natural stain or painted to blend with the house exterior and/or trim. Lattice shall be pressure treated wood (1"x2" minimum suggested, square type not diagonal), vinyl allowed if having the three dimensional appearance of wood (flat vinyl is not allowed), and color shall match trim color of house, trim or any existing fencing.

Requirements:

All screening and enclosures must be maintained in an aesthetic, safe and good condition (pressure-washing, painting, etc.). Trash and recycling areas must be kept clear; no loose debris shall be allowed in these areas.

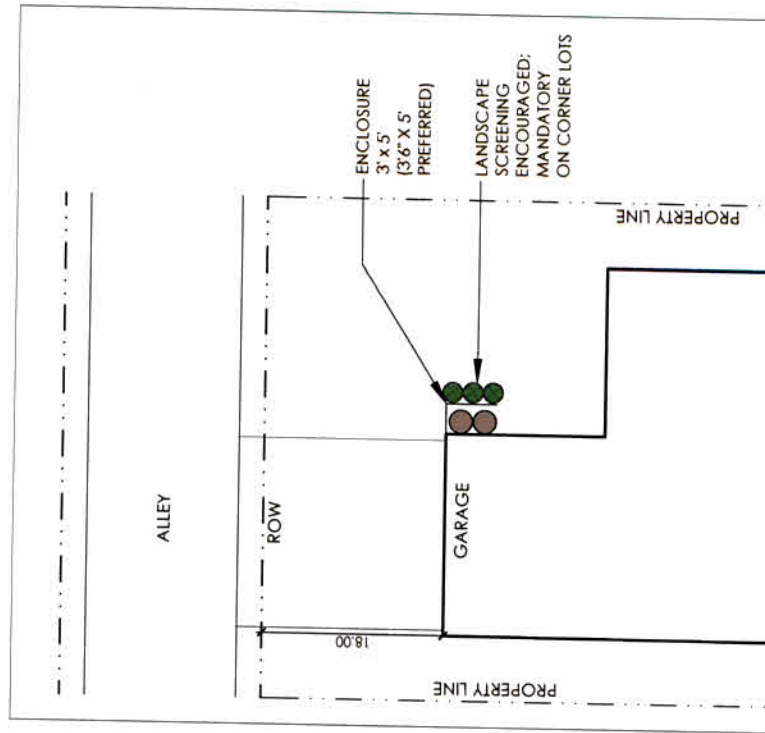

REAR OF HOUSE

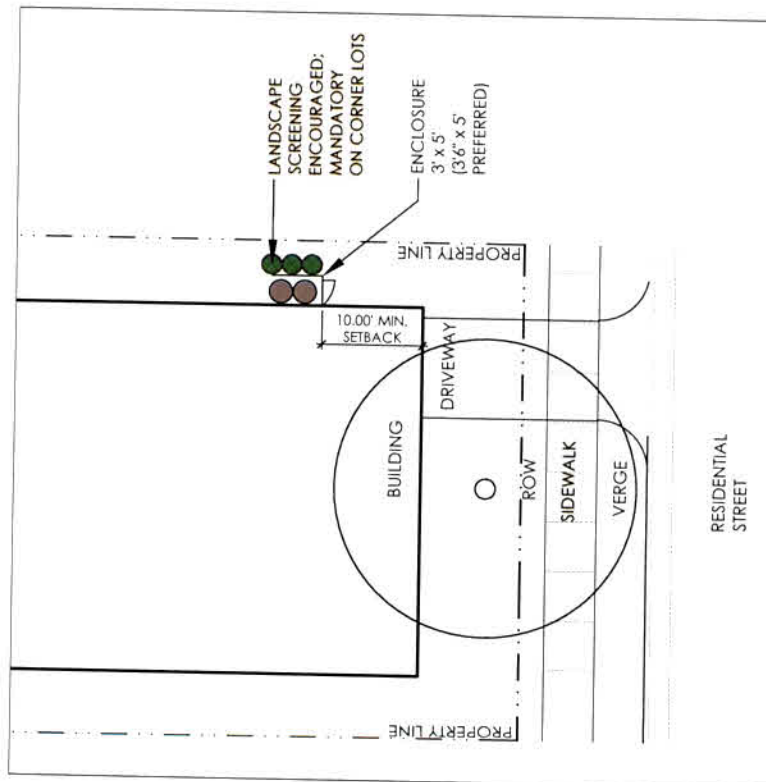

FRONT OF HOUSE